

## Digital Spreader Control (DS2)

- Manual or automatic mode
- Open-loop or closed-loop
- Magnetic or electronic sensors
- Digital display lbs/mile or accumulated pounds
- Your choice of proportional valve and hydraulic system
- Advanced troubleshooting features
- New equipment or retrofits
- Granular control
- Communication port for a field printer



The DS2 is the ideal spreader control for the equipment designer who has to make choices. Right out of the box, this high performance digital controller allows you to choose from a variety of features to best fit your application. The DS2 works with most valves and sensors allowing you to quickly implement a reliable and full-featured spreading system.

The DS2 offers a digital display for easy day or night viewing of the spread rate and has an optional "EL" style back-lit panel. A unique totaling feature calculates the accumulated pounds which have been dispensed. The controller alerts you to failed sensors, valve coils, cables, hydraulic stall, blast, zero mph and feed rate limited. The DS2 uses a special valve trim feature to automatically rescale the control knob for full sensitivity. Adjustable PWM frequency and output scaling make the DS2 usable with most any proportional valve.

The DS2 offers a RS232 communication port to download trip total to a field printer, DS2FP. For simplicity, this makes your data available for reporting results and tracking historical information.

The DS2 is a rugged compact design using a minimum parts count for higher reliability. The enclosure is urethane painted steel with heavy duty sealed switches, friction lock knobs and sealed pots. The field wiring is via single 9 pin twist lock connector. The unit can be panel or console mounted.

## Programmable features:

- PWM frequency 30 HZ to 270 HZ
- Spinner valve min. and max. limits
- Auger valve min. and max. limits
- Ground speed sensor counts/mile
- Open loop auger mode lbs/minute
- Closed loop auger mode lbs/pulse
- Blast timer 0 to 30 seconds
- Maximum lbs/mile 300 to 3000
- Gear box ratio 5:1 to 1:1 dual product switch ratio 5:1 to 2:1
- Valve monitor (on/off)
- Spot and 2-speed spreading options
- Truck number

## Mechanical Layout:

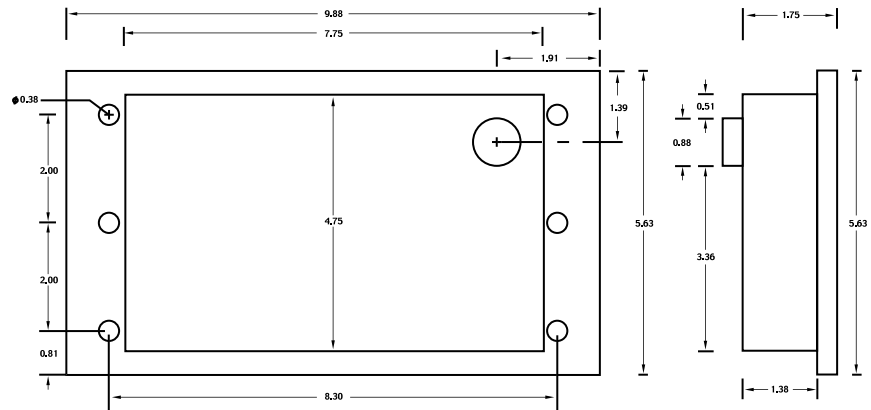

## Electronic Specifications:

- Supply input voltage 7.5 VDC to 16 VDC
- Input current 350 MA plus valve drive
- Output (2) PWM 12 VDC, 2.5 amps, spike suppression
- Output frequency 30 HZ to 270 HZ adjustable
- Counter inputs (2) hall effects pulse counter NPN type VRM inductive with sine wave output (3K OHM)
- Hydraulic stall external N.O. PSI switch (open-loop)
- Hydraulic stall calculated internally (closed-loop)
- Input power protected for reverse polarity

## General Wiring Arrangement:

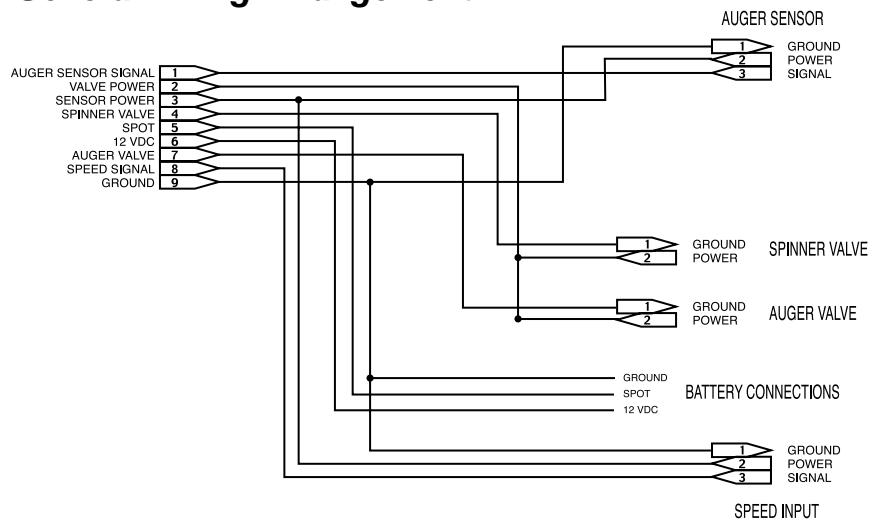

## Additional Features

Manual mode provides the operator with direct control in addition to a reliable backup system.

Valve monitor feature that continuously monitors the integrity of the valve and connections.

Complete cable sets are available as per system requirements. Please consult your dealer.

One-year warranty on all parts and labor F.O.B. factory. All repair work offered on a rush turn-around. Low cost field testers are available.

For more detailed product information, please contact your local dealer.

## Starting A Revolution!

Distributed by:

Des Moines, IA (800) 333-7411  
 Minneapolis, MN (800) 888-7411  
 Mundelein, IL (888) 905-7411

Perrysburg, OH (800) 374-7411  
 St. Louis, MO (800) 999-7411

or call our corporate  
 headquarters for a  
 location near you

**Component Technology**

A DIVISION OF  
 Certified Power Inc.

phone: 847-573-3818  
 fax: 847-573-3836